

Emergency exit - Self breaking glass

GSP-1105-E/B



The self-breaking glass is a patented emergency exit system specially designed for clean rooms and laboratories.

Principle

It is fitted at the place of a glazed panel and door with panic hardware. In the event of an accident, simply break the glass by jumping through the self-breaking panel.
The beading has been specially designed so that the panel easily breaks without injuring the user.

Technical characteristics

It is made up of a beaded, easily-split, transparent panel (polymethacrylate of methyle 100%), mounted on an aluminium lacquered frame; almost flush profiles provide an excellent fit.

2 standard configurations are available:

- 1 opening unit (opening dimensions: 900 mm 35.4" x 1990 mm 78.3")
- 2 opening units (opening dimensions: 1400 mm 55.1" x 1990 mm 78.3")

Other dimensions are available on request.

It is designed to work with a pressure variation from 20 Pa 0.003 PSI to 50 Pa 0.007 PSI.

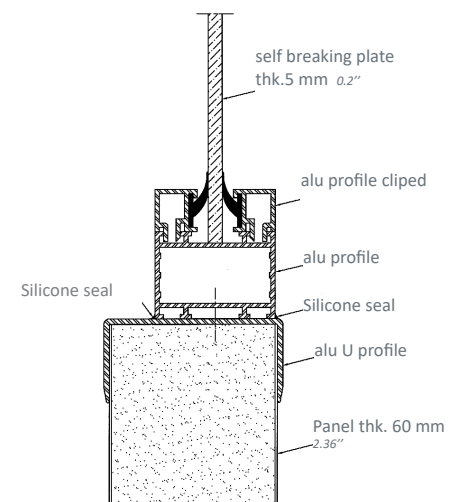

Recommendations and safety

- Mount an « emergency exit » lighted box sign above the self-break glass in compliance with current legislation.
- Near the self-break panel, mount the user instructions pictogram delivered with the product.
- Before putting your self-break panel in service, make sure you receive approval from your local safety commission.



Pictogram instructions for use